

Installation method 1. Adjustable width tank mounts

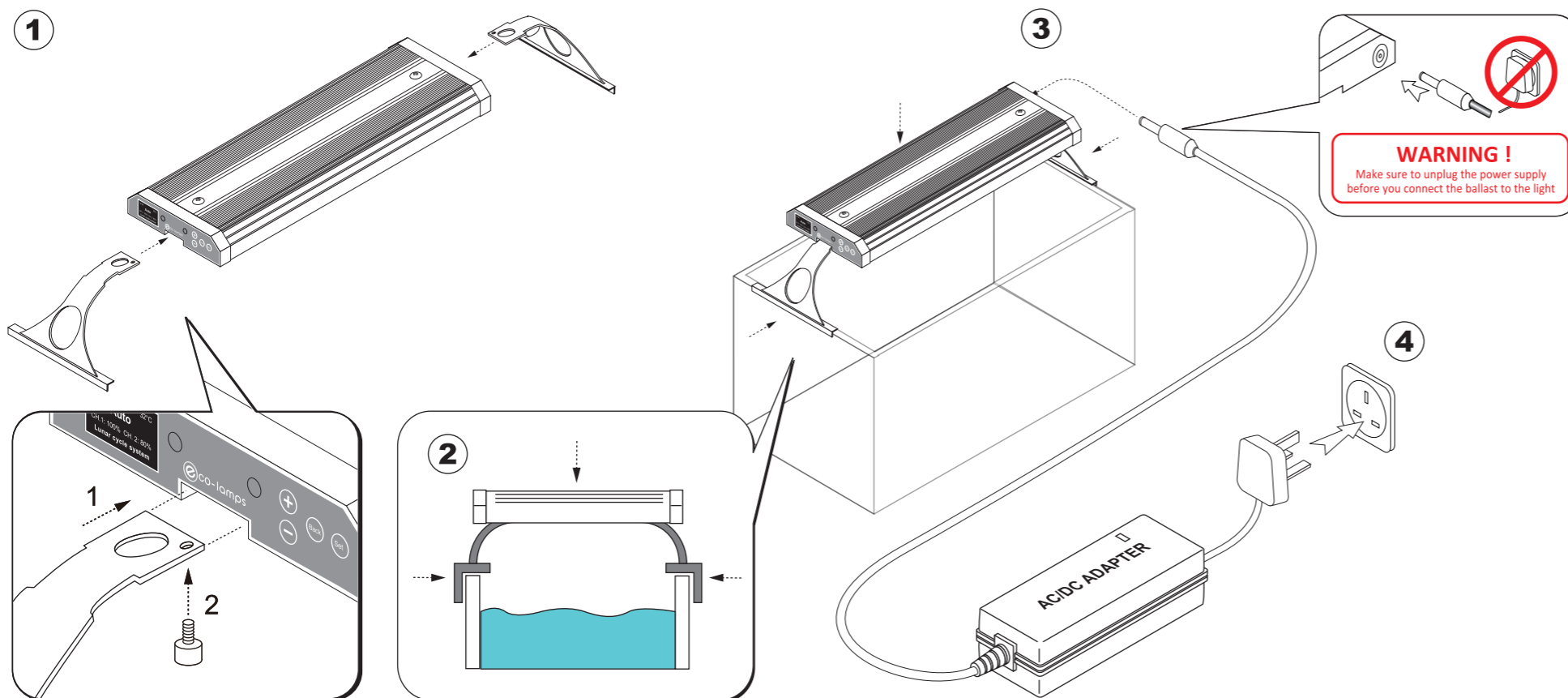

KR90 Series
User Guide
KR90DR / KR90FW

Installation method 2. Ceiling mounts

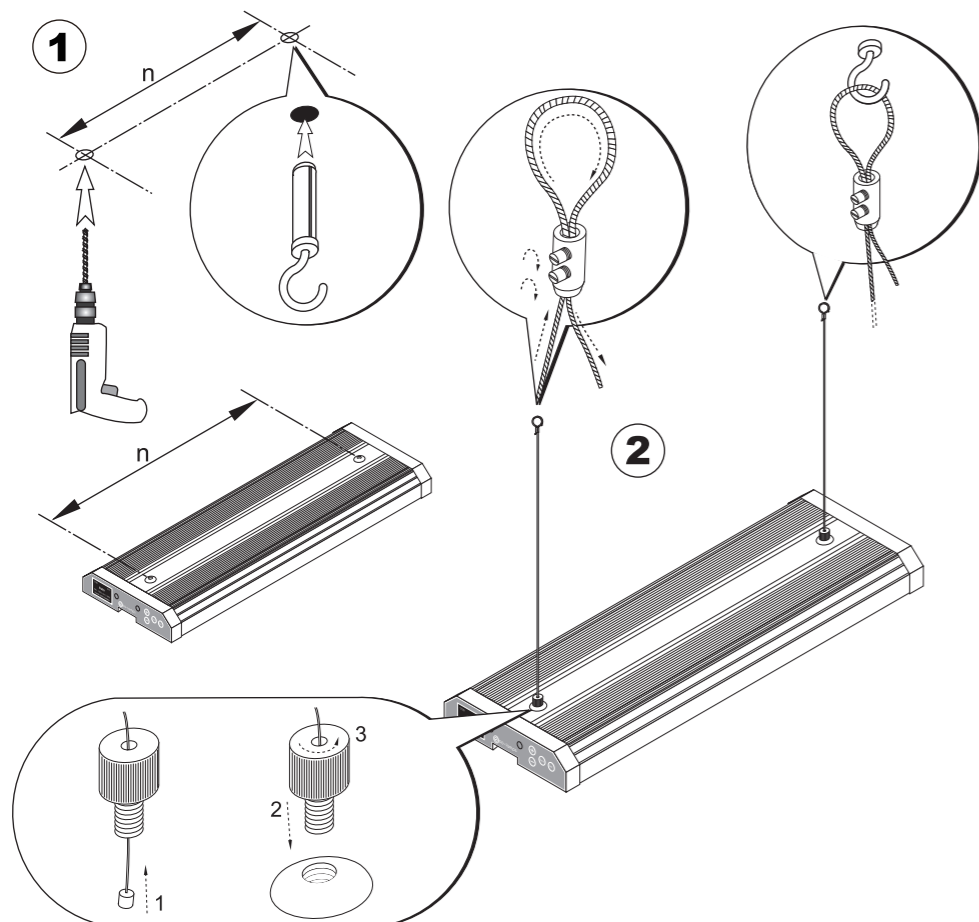

Multiple connection

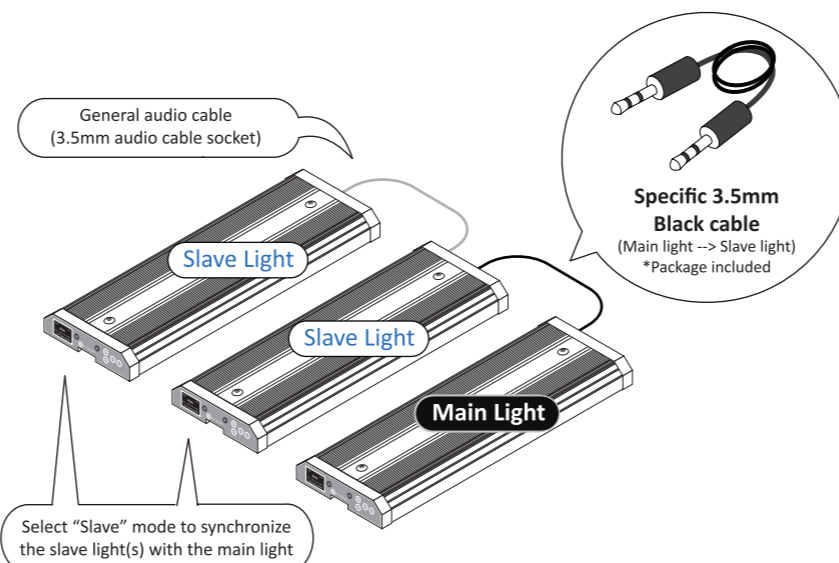

You may be able to connect several lights to each others. To do so, you need to connect the main light to a slave light by a specific 3.5mm Black cable which is included in the package. Please use a general 3.5mm audio cable for connecting between the slave light(s). Meanwhile the slave light(s) should be changed to "Slave" mode.

"Slave" mode
Press "+ / -" button to select "Slave" mode in the light menu.

FEATURES

- Heat is radiated away from water
- Fluorescent light / Metal Halide replacement
- Reliable, advanced and efficient aquarium illumination
- Specific LED light penetration
- Long life time, energy saving

SAFETY INSTRUCTIONS

- Make sure the power cord meets all relevant local safety standards
- Place the light near a wall outlet where the power cord can be easily unplugged
- Do not let the power cord become damaged or frayed
- Do not place the light near heaters
- Do not extend the wire. Doing this might affect the operation of the light
- Do not expose to direct sunlight or excessive heat

WARNING

- To prevent electrical shock, make sure you have unplugged the power cord from the electrical socket before cleaning the light
- To avoid electric shock, please do not touch the cord with wet hands

CAUTION

DO NOT attempt to service the fixture yourself. Doing this may render this warranty void.

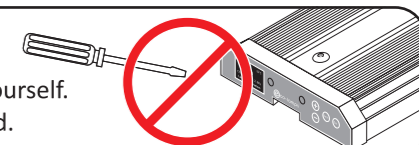

USER'S GUIDE

KR90DR / KR90FW

Light channel

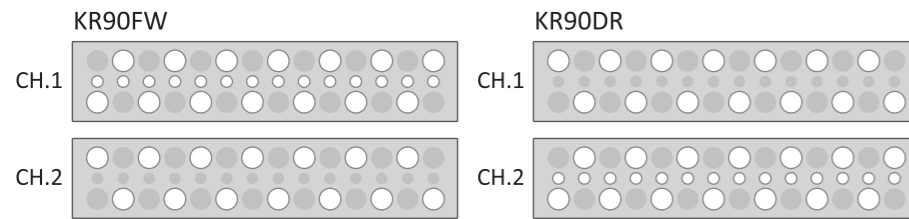

Control panel

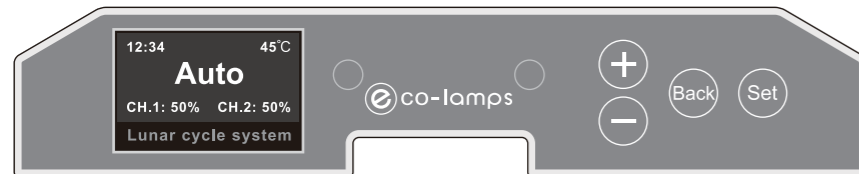

1. Button

- Press to scroll through the menus and options
- Use this key to cancel or back to previous page
- Use this key to select or enter

2. Light mode

Press to toggle 6 light modes in the menu.

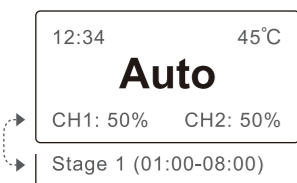

- Auto** 7 programmable light stages
- Manual** Manual setting of 1ch & 2ch (0-100%)
- Demo** Demonstration mode of a light display
- Thunder** LED blink to simulate the thunder effect
- OFF** LED stop operation
- Slave** Synchronize with the main light

3. Menu

In homepage, press to enter the menu.

Press to toggle 6 items (2pages) in the menu.

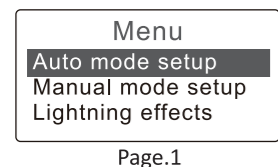

- Auto mode setup** Auto mode setting
- Manual mode setup** Manual mode setting
- Lightning effects** Lightning effect setting
※ Operate in auto mode only

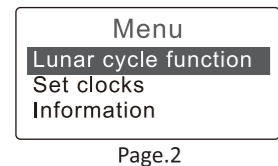

- Lunar cycle function** Lunar cycle setting
- Set clocks** Set date & time
- Information** Reset light settings & info. of firmware

Back side

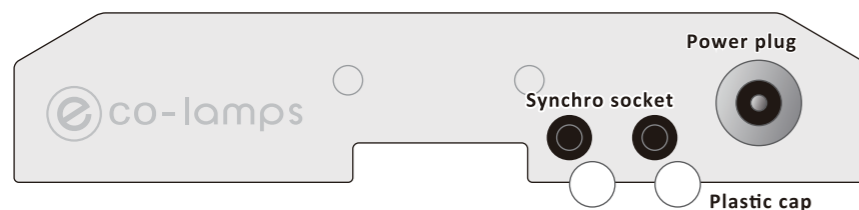

In order to use the synchro function, remove the plastic caps of synchro socket on the back of the light. Please connect the main light to a slave light by a specific 3.5mm Black cable which is included in the package.

Auto mode setup

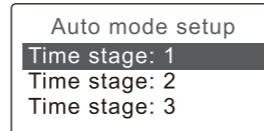

- 1) Select **Auto mode setup**, press to enter
- 2) Select **Time stage: 1**, press to enter Time stage 1
- 3) In the setting of **Time stage: 1 ~ Time stage: 7**

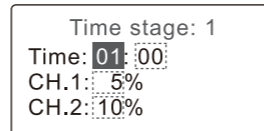

- Select **Time**, press to enter time setting
- press to edit begin time of each time stage
- Select **CH.1** / **CH.2**, press to enter CH. setting
- press to edit intensity of CH.1 / CH.2 0-100%

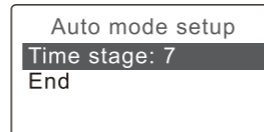

- 4) Select **End**, press to set the end time of the light
- 5) Press return to homepage and setting is complete

Manual mode setup

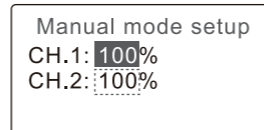

- 1) Select **Manual mode setup**, press to enter
- 2) Select **CH.1** / **CH.2**, press to enter CH. setting
- press to edit intensity of CH.1 / CH.2 0-100%
- 3) Press return to homepage and setting is complete

Demo mode

1. CH.2 0% → 100% → 0% (8s)
2. CH.1 0% → 100% → 0% (8s)
3. OFF (4s)
4. CH.2 0% → 100% (5s)
5. CH.1 0% → 100% (5s)
6. Thunder (2 times / 4s)
7. CH.1 100% → 0% (5s)
8. CH.2 100% → 0% (5s)

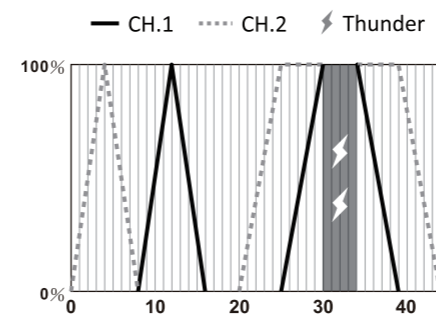

Lightning effects

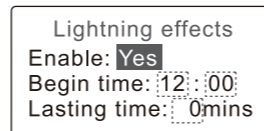

- 1) Select **Lightning effects**, press to enter
- 2) Select **Yes** to turn on lightning effects
- To stop the lightning effects, please select **No**

- 3) Select **Begin time**, press to edit the begin time of lightning effect
- Press to set the time: 12:00
- 4) Select **Lasting time**, press to edit the lasting time of lightning effect
- Press to set the lasting time: 10:mins
- 5) Press return to homepage and setting is complete

Lunar cycle function

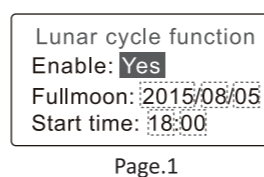

- 1) Select **Lunar cycle function**, press to enter
- 2) Select **Yes** to turn on lunar cycle function
- To stop the lunar cycle function, please select **No**
- 3) Select **Fullmoon**, press to set the date of fullmoon
- Press to set the date (Y/M/D) 2015 08 05 ※
- 4) Select **Start time**, press to edit the time: 18:00
- 5) Select **End time**, press to edit the time: 06:00
- 6) Select **CH. level**, press to set brightness of fullmoon 0-100%
- 7) Press return to homepage and setting is complete

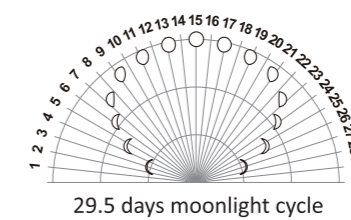
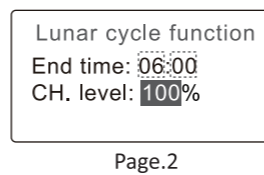

29.5 days moonlight cycle

※ Fixed 29.5 days cycle on the Moonlight

KR90 feature an advanced programmable controller that simulates the natural cycle of moonlight. Once you set a fullmoon date and turn on the lunar cycle function, the light will start running "29.5 days cycle" according to the fullmoon date.

Set clocks



- 1) Select **Set clocks**, press to enter
- 2) **Date**: Press to set the date (D/M/Y)
- 3) **Time**: Press to set the time (Hour:Minute)
- 4) Press return to homepage and setting is complete

Information

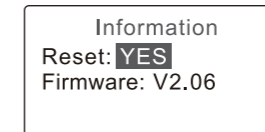

- 1) Select **Information**, press to enter
- 2) **Reset**: Press **Yes** to reset all settings to factory default
- ※ **Firmware**: Check the KR90 current firmware version

| Auto mode setting (Factory default setting) | | | | | |
|---------------------------------------------|------------|--------|--------|--------|--------|
| Time stage | Begin time | KR90DR | | KR90FW | |
| | | CH.1 % | CH.2 % | CH.1 % | CH.2 % |
| Time Stage: 1 | 00:00 | 02 | 04 | 04 | 02 |
| Time Stage: 2 | 06:00 | 10 | 20 | 20 | 10 |
| Time Stage: 3 | 08:00 | 40 | 60 | 60 | 40 |
| Time Stage: 4 | 10:00 | 80 | 100 | 100 | 80 |
| Time Stage: 5 | 14:00 | 80 | 80 | 80 | 80 |
| Time Stage: 6 | 16:00 | 60 | 40 | 40 | 60 |
| Time Stage: 7 | 18:00 | 02 | 04 | 04 | 02 |
| End | 00:00 | | | | |

Remark

When the light mode is changing, it may take a few seconds to a few minutes to reach the programmed brightness level.

Examples of wrong setting

"Time Stage 1" begin time: 07:00, "Time Stage 2" begin time: 06:00, "Time Stage 3" begin time: 09:00. In this case, "Time Stage 2" will be skipped, please set the begin time between "Time Stage 1" & "Time Stage 3"

ACCESSORIES

