

## UGL-HF010 Series

### Ordering Informations

Model No.	Color	Size	Light Source	Luminous Intensity
UGL-HF010WW	Warm White (3,000-3,500K)	Ø56x83mm	1x1W	90-100lm
UGL-HF010WE	Cool White (6,000-6,500K)	Ø56x83mm	1x1W	100-110lm

### Outline Drawing

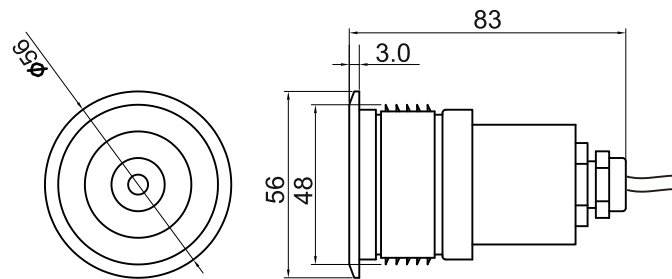

### Features

- Aluminum casing with special extrusions design
- Energy saving
- Eco-friendly product
- Long life time
- High luminance
- Low power consumption
- Weatherproof performance IP67
- Low surface heat against hand touch
- No UV or IR damage light sensitive items

\* The dimensional outline drawings are common in (UGL-HF010WW and UGL-HF010WE)

Unit: mm

### Specifications

Parameter	Rating value
Power Consumption	1W
Input Voltage	AC 85-220V, 50/60Hz
Light Source	1x1W power LED
Operating Temperature	- 40 to +70°C
Beam Angle	30°
Weight	450g
CRI	85
IP level	IP67

#### Warning:

- \* Do not look permanently to the light sources.
- \* Specified performance measured in 85-220Vac.

